



Electrolux

Instruction Book

EEK3505

Water kettle



GB INSTRUCTION BOOK

KO 설명서

ZH 說明手冊

ZH 说明书

VI SÁCH HƯỚNG DẪN

TH សៀវភៅ

JA 使用説明書

IN BUKU PANDUAN

CONTENTS

ENGLISH	5
한국어	X
中文(繁體)	X
中文(简体)	X
TIẾNG VIỆT	X
ภาษาไทย	X
日本語	X
BAHASA INDONESIA	X

WE'RE THINKING OF YOU

Thank you for purchasing an Electrolux appliance. You've chosen a product that brings with it decades of professional experience and innovation. Ingenious and stylish, it has been designed with you in mind. So whenever you use it, you can be safe in the knowledge that you'll get great results every time.

Welcome to Electrolux.

Visit our website to:



Get usage advice, brochures, trouble shooter, service information: www.electrolux.com



Register your product for better service: www.electrolux.com/productregistration



Buy Accessories and Consumables for your appliance: www.electrolux.com/shop

CUSTOMER CARE AND SERVICE

When contacting Service, ensure that you have the following data available. The information can be found on the rating plate. Model, PNC, Serial Number.



Warning / Caution-Safety information



General information and tips



Environmental information

Subject to change without notice.

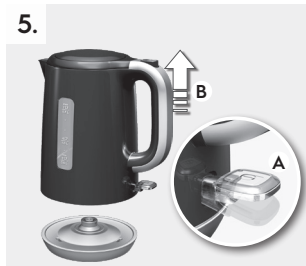

COMPONENTS

- A. Jug
- B. Removable mesh filter
- C. Spout
- D. Lid
- E. Opening lid button
- F. Handle
- G. Water level indicator
- H. ON/OFF switch with indicator light
- I. Separate base and mains cable

SAFETY ADVICE

Read the following instruction carefully before using the appliance for the first time.

- This appliance is not intended for use by persons (including children) with reduced physical, sensory or mental capabilities, or lack of experience and knowledge, unless they have been given supervision or instruction concerning use of the appliance by a person responsible for their safety.
- Children should be supervised to ensure that they do not play with the appliance.
- The appliance may only be connected to a power supply whose voltage and frequency comply with the specifications on the rating plate!
- Never use or pick up the appliance if
 - the supply cord is damaged,
 - the housing is damaged.
- The appliance must only be connected to an earthed socket. If necessary an extension cable suitable for 10 A can be used.
- If the appliance or the supply cord is damaged, it must be replaced by the manufacturer, its service agent or similarly qualified person, in order to avoid hazard.
- Always place the appliance on a flat, level surface.
- Never leave the appliance unattended while connected to the supply mains.
- The appliance must be switched off and the mains plug withdrawn each time after use, before cleaning and maintenance.
- The appliance and accessories become hot during operation. Use only designated handles and knobs. Allow to cool down before cleaning or storage.
- Do not immerse the appliance in water or any other liquid.
- Do not use or place the appliance on a hot surface or near source of heat
- Warning: Avoid spillage on the connector.
- Attention: The heating element surface is subject to residual heat after use.
- The mains cable must not come into contact with any hot parts of the appliance.
- This appliance is intended for domestic use only. The manufacturer cannot accept any liability for possible damage caused by improper or incorrect use.
- Attention: If the kettle is overfilled there is a risk that the boiling water may spray out, which could scald or burn! Therefore never fill the kettle above the maximum marking.

- Never operate appliance with open lid.
- Only use the kettle for heating water!
- The kettle can only be used with the stand provided.
- The mains cable or anything else must do not touch the power switch. Failure to do so could result in the auto shut off function not to work correctly and therefore in a risk of overheating or fire.
- While water boiling, avoid contacting with steam from the spout when water is boiling or just after it has switched off. Do not be anxious to uncover the lid.
- The heating element surface is subject to residual heat after use.
- The mains cable must not come into contact with any hot parts of the appliance.
- Do not put water into the appliance when it is hot!
- **WARNING:** Do not remove the lid while the water is boiling.
- **CAUTION:** Position the lid so that steam is directed away from the handle.
- **Caution:** If the kettle is overfilled, boiling water may be ejected.

This appliances is intended to be used in household and similar applications such as:

- staff kitchen areas in shops, offices and others working environments;
- farm houses;
- by clients in hotels, motels and other residential type environments;
- bed and breakfast type environments.

GETTING STARTED

1. **Before first use**, wipe the inside and outside of the kettle with a damp cloth.
2. **Place the base unit** on a firm and flat surface. Plug the mains plug into a wall socket. Redundant cord can be wound into the bottom of base unit.
3. **Press the button to open the lid**, pour water into the kettle. Make sure water level is visible in the water level indicator, but not exceeding the Max. mark.
4. **Close the lid** and make sure it snaps in correctly. Otherwise the auto switch off function will not work reliably. **Place the kettle onto the base**. Press down the ON/OFF switch; the indicator light will illuminate and the kettle will start to heat up.
5. **The automatic switch off function**. When the water has boiled or the kettle is moved from the base, it will switch off automatically. If you wish to stop the heating process before the water is boiling, simply lift up the ON/OFF switch to the OFF position.

CLEANING AND CARE

6. **Before cleaning, always unplug the appliance**. Never rinse or immerse the kettle or base unit in water. Just wipe with a damp cloth, using no abrasive detergents. Occasionally rinse out the kettle with clean water.
7. **To clean the mesh filter**, grab the strainer insert and lift out. **Cleaning the heating plate** – superficial spots of rust may appear on the base unit. Remove with a stainless steel cleaning agent.
8. **Decalcifying** is recommended regularly, depending on water hardness. Fill the kettle with water and decalcifier according to decalcifier product instructions. Do not boil the solution as it may foam over. Afterwards, rinse kettle thoroughly with fresh water.

TROUBLESHOOTING

Problem	Possible cause	Solution
The appliance switches off before boiling.	Too much lime scale at the base of the kettle.	Run the decalcifying procedure.
The appliance does not switch off.		Close lid until it locks
		Insert the strainer correctly.
The appliance cannot be switched on.	After operating with little or no water, the appliance has not cooled down sufficiently.	Allow to cool a short time and try again.

DISPOSAL

Recycle the materials with the symbol .
Put the packaging in applicable containers to recycle it.
Help protect the environment and human health and to recycle waste of electrical and electronic appliances.

Do not dispose appliances marked with the symbol  with the household waste. Return the product to your local recycling facility or contact your municipal office.



3482 E EEK3505 02 01 0315

Share more of our thinking at www.electrolux.com

electrolux.com/shop



Electrolux Floor Care AB
S:t Göransgatan 143
S-105 45 Stockholm
Sweden